

Body System (01.00)

Interior Trim (01.05)

This section covers removal and installation of the interior mouldings and trim panels. In many instances, one component overlaps another component. If this condition is found, it will be necessary to loosen or remove the overlapping component before removal, to prevent damage to either component.

Specifications

Torque Figures		
Description	Nm	lb. / ft.
Door Handle	9	6.5
Seat Belt Mounts	35	26

Maintenance

IP Trim

If required, removal of the IP trim can be achieved while the IP is in the vehicle.

Remove

1. Panel (1)- Pull off.
2. Hood (2) - Pull off.
3. Panel (3) - Pull off.
4. Panel (4) - Pull off. Disconnect the air temperature pipe.
5. Panel (5) - Front, screws (x3)
6. Glove box.
 - 6.1 Pull of the outer trim panel. Disconnect the glovebox release switch wiring harness plug.
 - 6.2 Release the damper cord.
 - 6.3 Remove screws (x3) from the glovebox door hinge. Remove door.
 - 6.4 Remove screws (x4) from the sight shield. Remove the sight shield and glovebox.
7. Panel, Airbag (7).

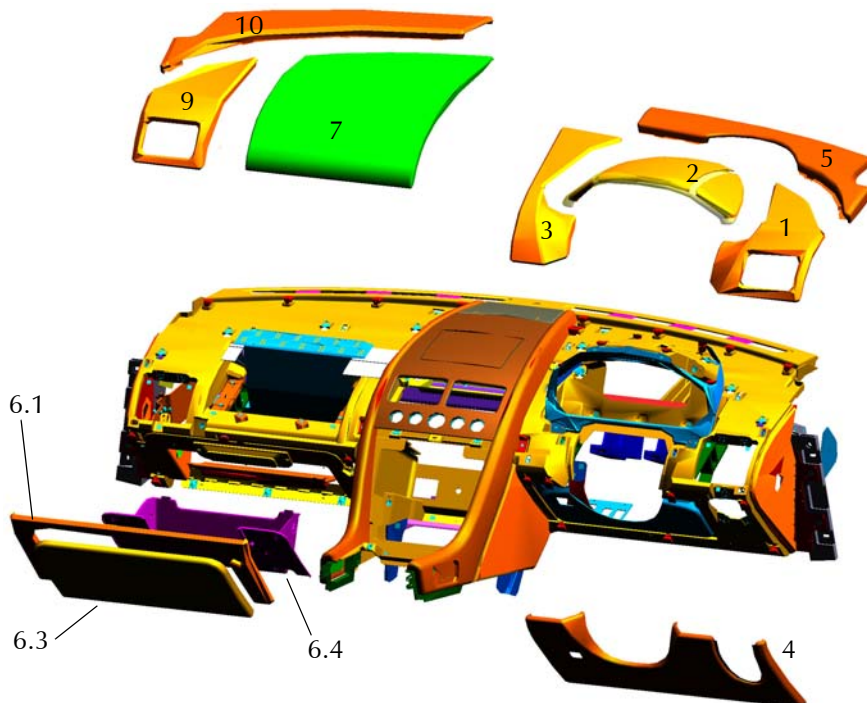

Caution
Withdraw the airbag panel carefully. The airbag panel can crease if forced out.

- 7.1 Remove screws (x3).
- 7.2 Lift from the front edge. Withdraw out of clips (x3).
8. Remove the airbag.

Warning ⚠

When removed, place the airbag in a secure container to prevent personal injuries if the airbag activates.

- 8.1 Disconnect the wiring harness plugs (x2).
- 8.2 Remove bolts (x4). Withdraw the airbag.
9. Panel (9) - Screws (x2), then pull off.
10. Panel (10) - Screws (x4).

11. If required, remove the center stack.
 - 11.1 Pull off the veneer panel (Service tool No. TBA). Disconnect the wiring harness plugs.
 - 11.2 Remove the speaker grill - Screws (x2).
 - 11.3 Remove the center panel (Radio etc.) - Screws (x4)
 - 11.4 Remove the center stack - Screws (x6).
 - 11.5 Remove the media player - Screws (x2). Disconnect the wiring harness plugs.

Installation Notes

The panels, etc., are best replaced in the order they were removed. Note the following:

1. When installing the glovebox shield ensure that the tab in the top centre locates into the slot in the substrate.

Roof Trim

Removal

1. Remove (pull away) the cant rail.

The cant rail is held in by 'FirTrees'.

The front of the cant rail is held in place by the 'IP'. Pull the cant rail away from the back first then pull the front out from the 'IP'.

2. Remove the interior mirror (screw x1).
3. Remove the reading lamp pod (clips x2, screw x1, wiring harness plugs x2)
4. Remove the sun visors (screws x2 (x2)).

The front headlining will fall away.

5. Remove the headlining.

Held in place with 'FirTrees' and two velcro panels at the rear.

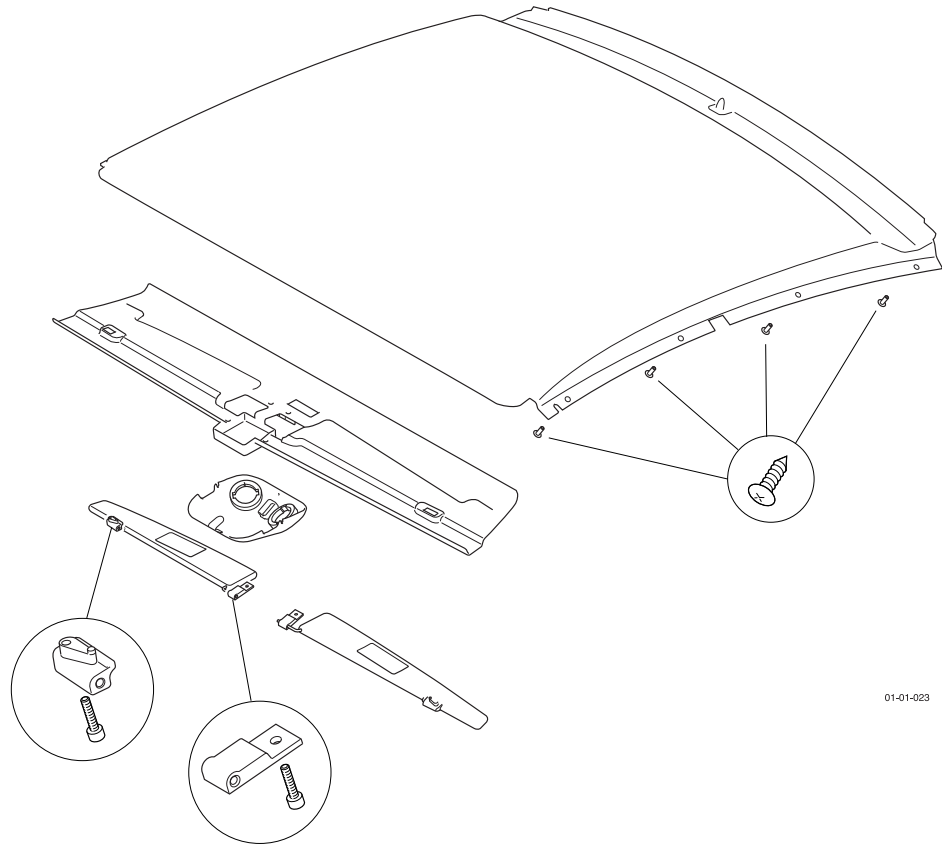

01-01-023

Installation

1. Install the roof lining.
2. Install the front headlining.
While holding the front headlining in place install the sun visors.
3. Install the interior mirror.
4. Install the cant rails.
Place the front of the cant rail into location at the IP, and work towards the rear, locating the 'FirTrees'.